

Driven & Static Tool Holder



Axial Offset Tool Holder (Internal Coolant)

DIN 5480

- Tool Holder is produced in accordance with DIN 69880.
- Driven Coupling is according to DIN 5480.
- ER Collet is according to DIN6499.
- For left hand and right hand turret.

- ⚙ Gear Ratio : 1 : 1
- ⚙ R.P.M. : Max. 5,000 RPM
- ⚙ Internal Coolant : 70 bar

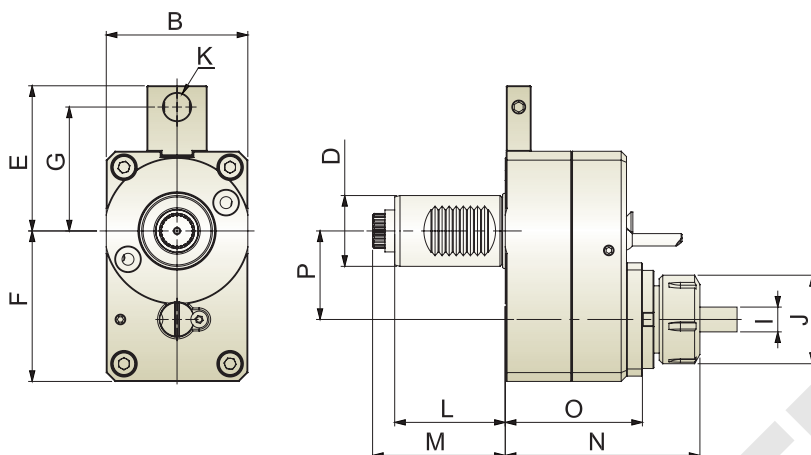

Unit : mm

Model No.	B	D	E	F	G	I	J	K	L	M	N	O	P	N.W.(KG)
THB-C04.29-30BI	64	30	49/57/59	58.5	40/48/50	ER25 (2~16)	42	13	55	67	99.5	83	29	3.0

Radial Tool Holder (External Coolant)

- ⚙ Gear Ratio : 1 : 1
- ⚙ R.P.M. : Max. 4,000 RPM

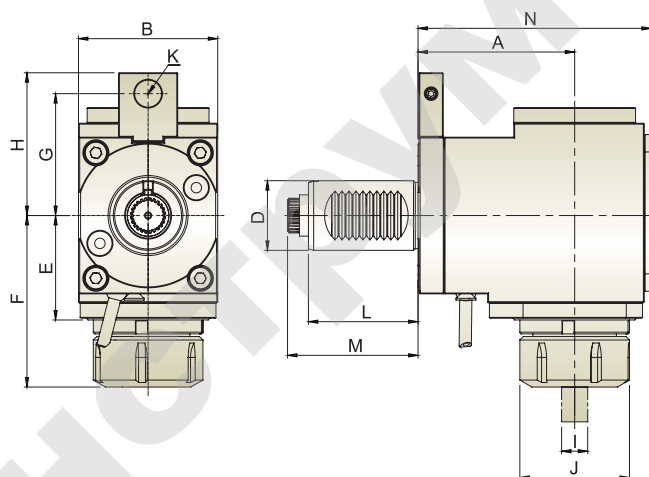

Unit : mm

Model No.	A	B	D	E	F	G	H	I	J	K	L	M	N	N.W.(KG)
THB-B02.48-20B	48	50	20	34.5	60.5	70	78.5	ER16 (1~10)	32	12	40	46.5	71.5	1.5
THB-B04.55-30B	55	64	30	39.5	66	40/63	50/73	ER25 (2~16)	42	12	45	59	86.5	3.0
THB-B04.85-30B	85	64	30	39.5	66	40/63	50/73	ER25 (2~16)	42	12	45	59	116.5	3.7
THB-B04.100-30B	100	64	30	39.5	66	40/63	50/73	ER25 (2~16)	42	12	45	59	131.5	4.2
THB-B05.65-40B	65	76	40	49	81.5	56/63/70	68/75/82	ER32 (3~20)	50	16	63	75	101	5.1
THB-B05.85-40B	85	76	40	49	81.5	56/63/70	68/75/82	ER32 (3~20)	50	16	63	75	121	6
THB-B05.100-40B	100	76	40	49	81.5	56/63/70	68/75/82	ER32 (3~20)	50	16	63	75	136	6.6
THB-B06.92-50B	92	86	50	60	100	63/70	76/83	ER40 (4~26)	63	18	78	92.7	136	9

※ Further option : 6000 RPM