

Driven & Static Tool Holder



Radial Tool Holder (Internal Coolant)

HAAS

- Tool Holder is produced in accordance with DIN 69880.
- Driven Coupling is according to HAAS.
- ER Collet is according to DIN 6499.
- For left hand and right hand turret.

- ⚙️ Gear Ratio : 1 : 1
- ⚙️ R.P.M. : Max. 4,000 RPM
- ⚙️ Internal Coolant : 70 bar

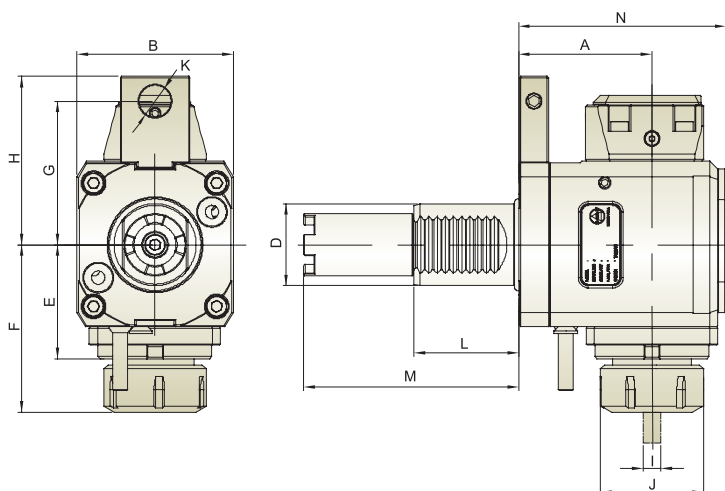

Unit : mm

Model No.	A	B	D	E	F	G	H	I	J	K	L	M	N	N.W.(KG)
THB-B05.65-40EI	65	76	40	49	81.5	63/70	75/82	ER32 (3~20)	50	16	51	104.85	101	5.1
THB-B05.65-40FI	65	76	40	49	81.5	63/70	75/82	ER32 (3~20)	50	16	51	117.55	101	5.1
THB-B06.90-40EI	90	80	40	60	98.5	63/70	75/82	ER40 (4~26)	63	16	51	104.85	134	8.3
THB-B06.90-40FI	90	80	40	60	98.5	63/70	75/82	ER40 (4~26)	63	16	51	117.55	134	8.3

※ Further option : 6000 RPM

Radial Female Thread Tool Holder (External Coolant)

- ⚙️ Gear Ratio : 1 : 1
- ⚙️ R.P.M. : Max. 4,000 RPM

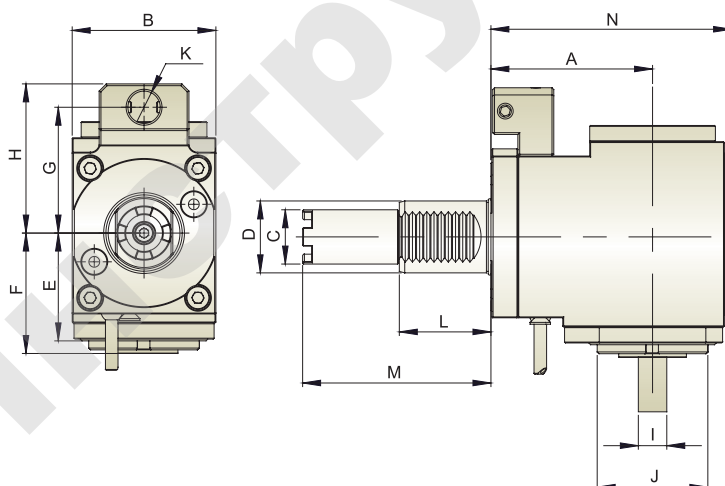

Unit : mm

Model No.	A	B	C	D	E	F	G	H	I	J	K	L	M	N	N.W.(KG)
THB-B12.90-40E	90	80	30	40	60	67	63/70	75/83	ER32 (3~20)	62	16	51	104.85	134	5.1
THB-B12.90-40F	90	80	30	40	60	67	63/70	75/83	ER32 (3~20)	62	16	51	117.55	134	5.1

※ Further option : 6000 RPM