

Driven & Static Tool Holder



Axial Tool Holder (External Coolant)

DIN 1809

- Tool Holder is produced in accordance with DIN 69880.
- Driven Coupling is according to DIN 1809.
- ER Collet is according to DIN 6499.
- Supply external coolant.
- For left hand and right hand turret.

 R.P.M. : Max. 6,000 RPM

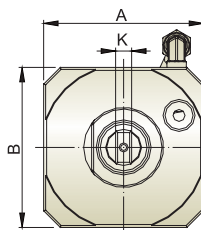
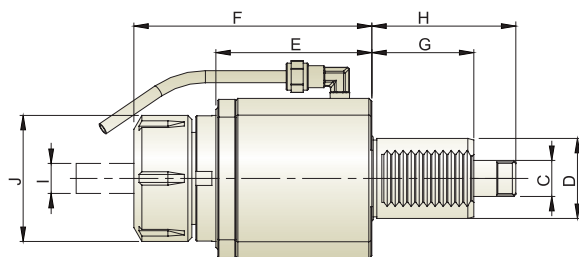

Unit : mm

Model No.	A	B	C	D	E	F	G	H	I	J	K	N.W.(KG)
THB-A04-30A	62	62	12	30	60.5	87	45	62	ER25 (2~16)	42	6	2.0
THB-A05-30A	64	64	12	30	64	98	45	62	ER32 (3~20)	50	6	2.3
THB-A05-40A	78	78	18	40	63	94	51	72	ER32 (3~20)	50	8	3.4
THB-A06-40A	80	80	18	40	78	119	51	72	ER40 (4~26)	63	8	4.3
THB-A06-50A	86	86	25	50	82	124	68	92	ER40 (4~26)	63	13	5.5
THB-A07-60A	104	104	27.8	60	110.5	152	78	110	ER50 (12~34)	78	14	9.6

Axial ER Tapping Tool Holder (External Coolant)

 R.P.M. : Max. 3,000 RPM

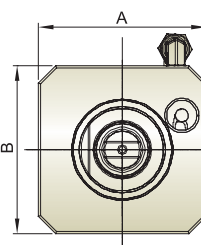
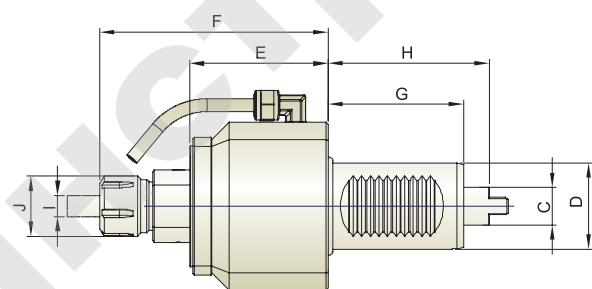

Unit : mm

Model No.	A	B	C	D	E	F	G	H	I	J	N.W.(KG)
THB-A15-40A	78	78	18	40	63	106	51	72	M3~M12	28	3